

SUPERPRO

For the chimney professional who demands the best

A SELKIRK COMPANY

SUPERVENT PRODUCTS INC. 375 GREEN ROAD, STONEY CREEK, ON L8E 4A5 TEL: 1-800-263-9308 FAX: 1-905-662-5352

Introducing a better quality chimney to top off all stove installations. SUPERPRO offers the latest technology in factory-built chimney design - providing superior performance, durability and safety. Years of development and design have combined the highest quality stainless steel, superior low chloride insulation, built-in safety features, and flexible installation options making SUPERPRO the best choice, every time.

SUPERPRO Chimney, Elbows and Tees, use 304 stainless steel throughout. This grade being an austenitic stainless steel adds substantial quantities of nickel (Ni) to high chromium alloys which provides superior resistance to corrosion at temperature ranges that exceed test standards. The brushed finish of 304 stainless provides a very rich and distinguished look which complements this superior product. SUPERPRO is the most corrosion resistant chimney in the industry today and will stand the tests of time for years to come.

Advanced engineering and testing have also made SUPERPRO a safer and cleaner burning chimney. While the outer casing temperature maintains a 2" clearance to combustibles, the inner liner can withstand temperatures of 2100° F and will stay hot to prevent creosote build up. The smooth inner liner produces rapid stabilization of strong draft ensuring efficient operation of the latest, high tech stoves. In addition, embossed couplers prevent moisture penetration to the inside, virtually eliminating any chance of corrosion.

All additional component parts of the SUPERPRO line of chimney products are made from galvalume - a state of the art combination of aluminum, zinc and silicon, providing twice the corrosion resistance of galvanized steel.

SUPERPRO is easy to install. Its compact, twist-lock design makes assembly safe and quick, without requiring special tools. The slim design allows flexible location options while minimizing use of valuable floor space.

With a 25 year limited warranty to back up all of these benefits, the complete SUPERPRO chimney system is the smart choice, every time.

Stainless Steel Chimney

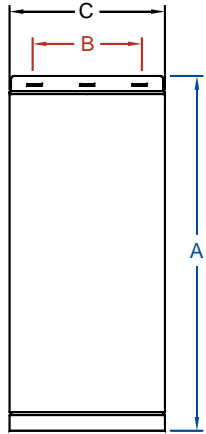

Chimney Sections

- High temperature -ANSI/UL 103.HT listed and tested to withstand temperatures of 2100°F.
- Slim, advanced design.
- Secure twist-lock design couples chimney sections together with just a 1/8 turn.
- Sectional overlap of 1-1/8".
- Chimneys are sized according to the inner diameter and are available in 6" and 8" diameters.
- Insulated chimney requires 2" clearance to combustible material.
- Superpro 2100 has a 1" wall thickness.

Size	Dimensions		
	A	B	C
5"	6",12",18",24",36"	5"	7"
6"	6",12",18",24",36"	6"	8"
7"	6",12",18",24",36"	7"	9"
8"	6",12",18",24",36"	8"	10"

5" diameter sections			6" diameter sections			7" diameter sections			8" diameter sections		
Size	Part#	Qty	Size	Part#	Qty	Size	Part#	Qty	Size	Part#	Qty
6" X 36"	SPR5L36	1	6" X 36"	SPR6L36	1	6" X 36"	SPR7L36	1	8" X 36"	SPR8L36	1
6" X 24"	SPR5L24	1	6" X 24"	SPR6L24	1	6" X 24"	SPR7L24	1	8" X 24"	SPR8L24	1
6" X 18"	SPR5L18	1	6" X 18"	SPR6L18	1	6" X 18"	SPR7L18	1	8" X 18"	SPR8L18	1
6" X 12"	SPR5L12	1	6" X 12"	SPR6L12	1	6" X 12"	SPR7L12	1	8" X 12"	SPR8L12	1
6" X 6"	SPR5L6	2	6" X 6"	SPR6L6	2	6" X 6"	SPR7L6	2	8" X 6"	SPR8L6	2

24" and 36" lengths are also available in a High Density Carton.

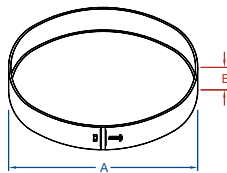

Stainless Steel Locking Bands

- Two flanges engage the grooves in each end of the adjoining sections holding them securely together.
- Must be used on all sections of chimney that make up an offset. This includes two locking bands per elbow plus one locking band for every chimney length between the elbows. Must also be used on tee branch to attach chimney length.
- While locking bands are not required on other chimney lengths, their use is recommended to provide a more attractive finished appearance high temp.

Size	Dimensions		Part #	Qty
	A	B		
5"	7"	1-3/8"	SPR5SLB	5
6"	8"	1-3/8"	SPR6SLB	5
7"	9"	1-3/8"	SPR7SLB	5
8"	10"	1-3/8"	SPR8SLB	5

Stainless Steel Tees and Elbows

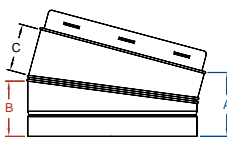

Insulated 15° and 30° Elbow Kits

- Includes 4 locking bands, 1 elbow support and 2 elbows.
- The insulated elbow is used when offset is required.
- Locking bands must be used on all elbows.
- Offsets cannot be more than 30° off the vertical.
- A maximum of 6 feet is allowable between offsets.
- Elbow is fully insulated and can be used at the same 2" clearance as chimney lengths.
- Elbow support must be used with all offset installations.
- Elbows do not have locking ridges and can be rotated to attain optimum positioning offset, and allow chimney to return to correct vertical alignment, prior to installing locking bands.

Size	Dimensions			Part #	Qty
	A	B	C		
15° - 5"				SPR5EL15K	2
15° - 6"	2-1/2"	2-7/8"	3-7/16"	SPR6EL15K	2
15° - 7"				SPR7EL15K	2
15° - 8"	2-3/4"	3-1/16"	3-1/2"	SPR8EL15K	2
30° - 5"				SPR5EL30K	2
30° - 6"	3-3/4"	3-7/8"	3-1/8"	SPR6EL30K	2
30° - 7"				SPR7EL30K	2
30° - 8"	4-1/2"	4-15/16"	4-1/8"	SPR8EL30K	2

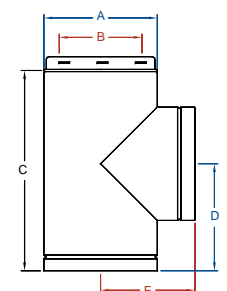

Insulated Tee with Plug

- The insulated chimney tee is used for through-the-wall installations using a wall support.
- A chimney length is attached to the tee branch using a locking band to pass safely through a wall.

Size	Dimensions					Part #	Qty
	A	B	C	D	E		
5"	7"	5"				SPR5ITP	1
6"	8"	6"	11-1/2"	5-5/8"	5-3/4"	SPR6ITP	1
5"	9"	7"				SPR7ITP	1
8"	10"	8"	13-3/8"	6-5/8"	6-1/2"	SPR8ITP	1

Insulated Tee

Size	Dimensions					Part #	Qty
	A	B	C	D	E		
6"	—	—	—	—	—	J51TP1	1
8"	—	—	—	—	—	J61TP1	1
7"	—	—	—	—	—	J71TP1	1
8"	—	—	—	—	—	J81TP1	1

Chimney Selection Chart

Chimney Height	Chimney Lengths Required			
	36"	24"	18"	12"
4'	1			1
5'	1	1		
6'	2			
7'	2		1	
8'	2	1		
9'	3			
10'	3		1	
11'	3	1		
12'	4			
13'	4		1	
14'	4	1		
15'	5			
16'	5		1	
17'	5	1		
18'	6			
19'	6		1	
20'	6	1		
21'	7			
22'	7		1	
23'	7	1		
24'	8			
25'	8		1	

If you require a 1/2 foot measure, use a 6" or 18" length to suit your needs.

Determining the Pitch of your Roof

To determine what roof flashing you'll require, you must work out the pitch of your roof. To determine the pitch, you'll need two rulers and a level. Measure the number of inches from the end of the level down to the roof.

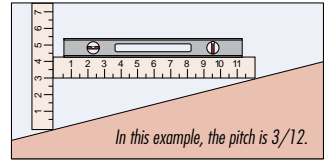

Height Requirements

The chimney must extend at least three feet above the highest point where it passes through the roof surface and at least two feet higher than any part of the building within a horizontal distance of ten feet.

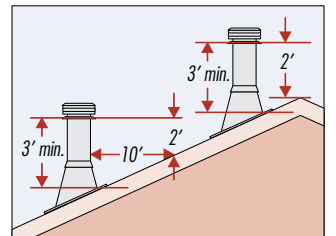

Chimney Offset Chart

This chart has three columns for elbow angle required to achieve your desired offset. The first column ("Offset") is the horizontal distance, at the chimney center line, of the offset needed to get around an obstacle. The second column ("Height") is the height of the assembled offset elbow to the top of the return elbow. Column 3 shows the appropriate lengths required.

- Determine the distance of the offset required.
- On the chart, find the predetermined distance required for the 15° elbow kit under the corresponding chimney diameter. For greater offset, use the 30° elbow kit.
- After finding the offset, follow across the chart to find the specified height and appropriate chimney lengths required under their corresponding diameters.

All measurements in inches. Construction tolerances ± one inch.

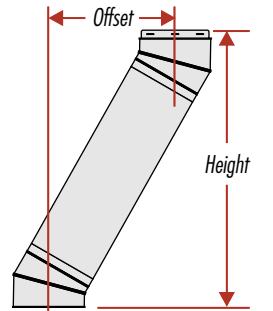

15° Offset Chart

Offset	Height				Lengths Required								
	5"	6"	7"	8"	5"	6"	7"	8"	6"	12"	18"	24"	36"
1-1/8					9-7/8			10-3/8	—	—	—	—	—
2-3/8					14-5/8			15-3/4	1	—	—	—	—
4					20-3/8			21-1/2	—	1	—	—	—
5-1/2					26			27-3/8	—	—	1	—	—
7-1/8					31-3/8			33-1/8	—	—	—	1	—
8-3/8					36-3/4			37-7/8	1	1	1	—	—
10-1/8					43-5/8			44-3/4	—	—	—	—	1
11					48-1/4			49-3/8	1	—	1	1	—
13					54-1/8			55-1/4	—	1	—	—	1
14-1/2					59-3/4			61-1/4	—	—	1	—	1
16					65-5/8			66-7/8	—	—	—	1	1
17-3/8					70-1/4			71-5/8	1	1	1	—	1
18-7/8					76-1/4			77-9/16	—	1	—	1	1

30° Offset Chart

Offset	Height				Lengths Required								
	5"	6"	7"	8"	5"	6"	7"	8"	6"	12"	18"	24"	36"
2-3/4					11-1/8			14	—	—	—	—	—
5-1/8					15-1/4			18-1/8	1	—	—	—	—
8-1/8					20-1/4			23-3/8	—	1	—	—	—
11-1/8					25-3/8			28-1/2	—	—	1	—	—
14-1/8					30-3/8			33-7/8	—	—	—	1	—
16-5/8					34-3/4			36-1/8	1	1	1	—	—
20-1/8					40-7/8			44-1/2	—	—	—	—	1
22-3/8					45-1/8			48-1/2	1	—	1	1	—
25-1/2					50			53-3/4	—	1	—	—	1
27-1/2					55-1/4			59-1/8	—	—	1	—	1
31-1/2					60-3/8			64-1/8	—	—	—	1	1
33-7/8					64-3/4			68-3/8	1	1	1	—	1
36-7/8					68-5/8			73-3/4	—	1	—	1	1

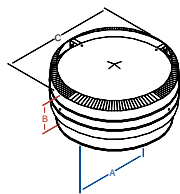

Premium Rain Cap

- Advanced design, premium quality stainless steel.
- Provides protection against precipitation and creates a venturi effect to enhance draught.
- Twist-lock connection for secure installation.

Size	Dimensions			Part #	Pack
	A	B	C		
5"	7"			SPR5DRC	1
6"	8"	7-1/8"	11-1/4"	SPR6PRC	1
7"	9"			SPR7DRC	1
8"	10"	7-5/8"	14-1/4"	SPR7PRC	1

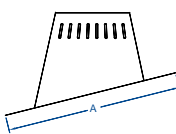

Adjustable Flashing Assembly - Flat to 6/12

- Used where the chimney passes through a roof with a pitch of 1/12 to 6/12.
- Comes complete with storm collar.
- All seams are sealed with silicone sealant.
- Galvalume construction.

Size	Dimensions			Part #	Pack
	A	B	C		
5"				JSC5AAF	1
6"	24"			JSC6AAF	1
7"				JSC7AAF	1
8"	27-1/2"			JSC8AAF	1
5"				JSC5AAF-3	3
6"	24"			JSC6AAF-3	3
7"				JSC7AAF-3	3
8"	27-1/2"			JSC8AAF-3	3

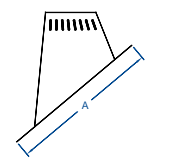

Adjustable Flashing Assembly - 6/12 to 12/12

- Used where the chimney passes through a roof with a pitch of 6/12 to 12/12.
- Comes complete with storm collar.
- All seams are sealed with silicone sealant.
- Galvalume construction.

Size	Dimensions			Part #	Pack
	A	B	C		
5"	30"			JSC5AF2	1
6"	30"			JSC6AF2	1
7"	30"			JSC7AF2	1
8"	30"			JSC8AF2	1
5"	30"			JSC5AF2-3	3
6"	30"			JSC6AF2-3	3
7"	30"			JSC7AF2-3	3
8"	30"			JSC8AF2-3	3

New Flashing ATC here

Size	Dimensions			Part #	Pack
	A	B	C		
5"				JSC5ATC	1
6"				JSC6ATC	1
7"				JSC7ATC	1
8"				JSC8ATC	1

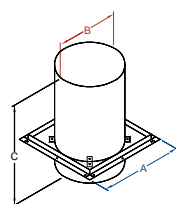

Firestop Radiation Shield

- Required where the chimney passes from a lower living space into an upper living space.
- Maintains the mandatory two inch clearance to combustibles.
- Shields the joist space from heat radiation.
- Galvalume construction.

Size	Dimensions			Part #	Pack
	A	B	C		
5"	11"	9"	19"	JSC5FRS	1
6"	12"	10"	19"	JSC6FRS	1
7"	13"	11"	19"	JSC7FRS	1
8"	14"	12"	19"	SPR8FRS	1

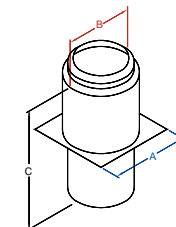

Firestop Attic Insulation Shield

- The FAIS is installed where the chimney passes through a second story living space into the attic.
- Extends down through the ceiling into the living space.
- Maintains the mandatory two inch clearance to combustible.
- Galvalume construction.

Size	Dimensions			Part #	Pack
	A	B	C		
5"	13"	11"	26"	JSC5FAIS	1
6"	14"	12"	26"	JSC6FAIS	1
7"	15"	13"	26"	JSC7FAIS	1
8"	16"	14"	26"	JSC8FAIS	1

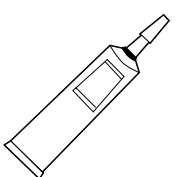

Caulking For Storm Collar

- Used to seal storm collar to chimney length above cone of flashing.
- 3 ounce tube

Size	Dimensions	Part #	Pack
		JRTV	1

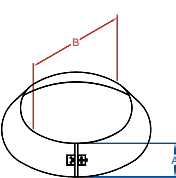

Galvalume Storm Collar

- Used in conjunction with roof flashing to keep precipitation out.

Size	Dimensions			Part #	Pack
	A	B	C		
5"	4-1/2"	7"		JSC5SC-1	1
6"	4-1/2"	8"		JSC6SC-1	1
7"	4-1/2"	9"		JSC7SC-1	1
8"	4-1/2"	10"		JSC8SC-1	1

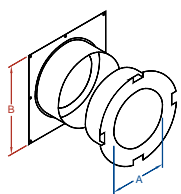

Black Wall Thimble

- Used in a wall support installation.
- Radiation shield is included with spacers which maintain the mandatory 2" clearance to combustibles.
- Attractive matte black finishing trim is included with stylish brass finishing trim.

Size	Dimensions		Part #	Pack
	A	B		
5"	7-1/8"	16"	SPR5WTB	1
6"	8-1/8"	16"	SPR6WTB	1
7"	9-1/8"	16"	SPR7WTB	1
8"	10-1/8"	16"	SPR8WTB	1

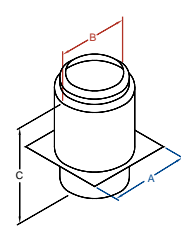

Attic Insulation Shield

- The AIS must be installed where the chimney enters the attic space in any installation.
- Designed to keep insulation away from the chimney, and to maintain the mandatory 2" clearance to combustibles.
- Must be used when installing through a second floor.

Size	Dimensions			Part #	Pack
	A	B	C		
5"	13"	11"	20"	JSC5AIS	1
6"	14"	12"	20"	JSC6AIS	1
7"	15"	13"	20"	JSC7AIS	1
8"	16"	14"	20"	JSC8AIS	1

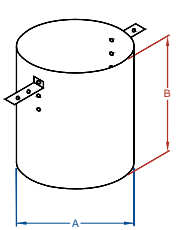

Rafter Radiation Shield

- The RRS must be installed where the chimney is enclosed immediately below the roof.

Size	Dimensions		Part #	Pack
	A	B		
5"	9"	12"	JSC5RRS	1
6"	10"	12"	JSC6RRS	1
7"	11"	12"	JSC7RRS	1
8"	12"	12"	JSC8RRS	1

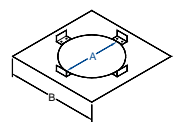

Finishing Plate

- Used where the chimney passes through a soffit to provide a finished appearance.
- Maintains the mandatory 2" clearance to combustibles.

Size	Dimensions		Part #	Pack
	A	B		
5"	7-1/8"	13"	JSC5FP	1
6"	8-1/8"	14"	JSC6FP	1
7"	9-1/8"	15"	JSC7FP	1
8"	10-1/8"	16"	JSC8FP	1

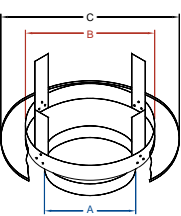

Decorator Ceiling Support

- For use in ceiling support installations.
- Supports up to 50 feet of chimney.
- Matte black with brass finishing ring, support gives a premium finished appearance.
- Stove pipe adapter included.

Size	Dimensions			Part #	Pack
	A	B	C		
5"	7-1/4"	11-3/8"		SPR5CSB	1
6"	8-1/4"	12-3/8"	17-7/8"	SPR6CSB	1
7"	9-1/4"	13-3/8"		SPR7CSB	1
8"	10-1/4"	14-3/8"	19-5/8"	SPR8CSB	1

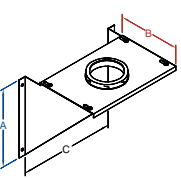

Adjustable Wall Support

- Used to support the chimney on a wall installation.
- Will support up to 30 feet of chimney.
- Includes wall support top plate with female coupler attached, male coupler, side brackets and hardware.

Size	Dimensions			Part #	Pack
	A	B	C		
5"	17-1/8"	10"	16"	JSC5AWS	1
6"	17-1/8"	11"	16"	JSC6AWS	1
7"	17-1/8"	12"	16"	JSC7AWS	1
8"	17-1/8"	13"	16"	JSC8AWS	1

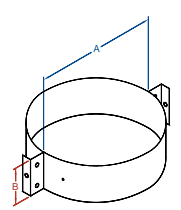

Elbow Support

- Must be used with all elbow installations.
- Will support up to 15 feet of chimney.
- Each support contains 2 hangers and 1 band.

Size	Dimensions		Part #	Pack
	A	B		
5"	7"	3"	JSC5ES	1
6"	8"	3"	JSC6ES	1
7"	9"	3"	JSC7ES	1
8"	10"	3"	JSC8ES	1

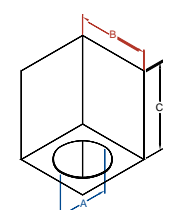

Cathedral Ceiling Support Box

- Used in pitched ceiling support installations.
- Supports up to 15 feet of chimney.
- Matte black finish with stylish brass finishing trim.

Size	Dimensions			Part #	Pack
	A	B	C		
5"	7-3/16"	11"	17"	SPR5CCSB	1
6"	8-3/16"	12"	17"	SPR6CCSB	1
7"	9-3/16"	13"	17"	SPR7CCSB	1
8"	10-3/16"	14"	17"	SPR8CCSB	1

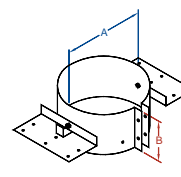

Roof Support

- The roof support may be used on a floor, ceiling or roof and adjusts to any roof pitch.
- It may be used above an offset to support the offset or as a supplementary support when the chimney height exceeds that of the primary support.
- The roof support will support a total height of 50 feet of chimney.

Size	Dimensions		Part #	Pack
	A	B		
5"	7"	5"	JSC5RS	1
6"	8"	5"	JSC6RS	1
7"	9"	5"	JSC7RS	1
8"	10"	5"	JSC8RS	1

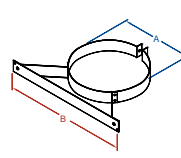

Wall Band

- Provides lateral support for the chimney when installed adjacent to a wall.
- Maintains the mandatory 2" clearance to combustibles.
- Used 4 feet above the tee, then every 8 feet thereafter.
- Stainless steel band.

Size	Dimensions		Part #	Pack
	A	B		
5"	7"	17"	JSC5WB	1
6"	8"	17"	JSC6WB	1
7"	9"	17"	JSC7WB	1
8"	10"	17"	JSC8WB	1

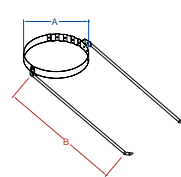

Adjustable Universal Roof Guy Kit

- Used when more than 5 feet of chimney extends from the roof.
- The kit includes two 5-foot rods and an adjustable band.
- Each rod extends to approximately 10 feet.
- The adjustable band will fit 6" to 8" size chimney.

Size	Dimensions		Part #	Pack
	A	B		
8 - 12"	60 - 120"		JURGK-1	1

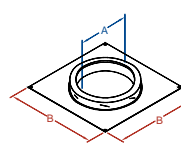

Adapter Plate

- The adapter plate is used to adapt the chimney to zero clearance fireplaces.

Size	Dimensions		Part #	Pack
	A	B		
5"	7"	11-5/8"	JSC5AP	1
6"	8"	11-5/8"	JSC6AP	1
7"	9"	11-5/8"	JSC7AP	1
8"	10"	11-5/8"	JSC8AP	1

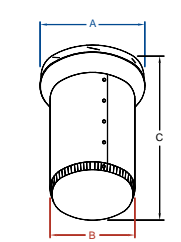

Black Stove Pipe Adapter

- For use with free-standing fireplaces and stoves for a quick and easy transition from black stove pipe or Double Wall black stove pipe to factory-built chimney.
- Easy connection to the stove. Easily installed from below supports.
- Twist-lock for easy connection.

Size	Dimensions			Part #	Pack
	A	B	C		
5"	7"	5"	12-1/4"	JSC5ASE	1
6"	8"	6"	12-1/4"	JSC6ASE	1
7"	9"	7"	12-1/4"	JSC7ASE	1
8"	10"	8"	12-1/4"	JSC8ASE	1

Decorator Ceiling Support Kit

Size	Dimensions			Part #	Pack
	A	B	C		
5"				SPR5CSK	1
6"				SPR6CSK	1
7"				SPR7CSK	1
8"				SPR8CSK	1

Cathedral Ceiling Support Kit

Size	Dimensions			Part #	Pack
	A	B	C		
5"				SPR5CCSK	1
6"				SPR6CCSK	1
7"				SPR7CCSK	1
8"				SPR8CCSK	1

Wall Support Kit

Size	Dimensions			Part #	Pack
	A	B	C		
5"				SPR5WSK	1
6"				SPR6WSK	1
7"				SPR7WSK	1
8"				SPR8WSK	1